

Kooltherm® K10FM Soffit Board

INSULATION FOR CONCRETE SOFFITS



- Super high performance rigid thermoset modified resin insulation
- Fibre-free insulation core
- Fire-rated to FM Global approval (Class No. 4880: Class1)
- Group 1 BCA fire classification
- Resistant to the passage of water vapour
- Easy to handle and install
- Ideal for new build and refurbishment
- CFC/HCFC-free with zero Ozone Depletion Potential (ODP)
- Compliant with AS/NZS 4859.1:2002



*Low Energy –
Low Carbon Buildings*

Kooltherm® K10FM Soffit Board

Product Description

Kingspan Kooltherm® K10FM Soffit Board is a super high performance, fibre-free rigid thermoset modified resin insulation core, sandwiched between an upper tissue-based facing and a lower facing of highly reflective aluminium foil autohesively bonded to the insulation core during manufacture.

Kingspan Kooltherm® K10FM Soffit Board is manufactured without the use of CFCs/HCFCs and has zero Ozone Depletion Potential (ODP).



Product Data

Emittance (Foil Face)	E0.14
Board Dimensions	2270 mm x 1200 mm (2.72 m ²)
Board Thickness	25, 30, 40, 50, 60, 70, 75, 80, 90 mm
Typical Density	40 - 42 kg/m ³
Typical Weight	2.7 kg - 10.3 kg per board depending on thickness and typical density

Thermal Performance

The figures below are only for a selection of product thicknesses. Please contact the Kingspan Insulation Technical Services Department for calculations on product thicknesses not listed here.

Insulation Thickness	Product R-value	Total R-value			
		Roof Application (150 mm concrete)		Unenclosed Sub-floor Application (150 mm concrete)	
		Heat In	Heat Out	Heat In	Heat Out
40 mm	R1.9	R _t 2.8	R _t 2.3	R _t 2.2	R _t 2.2
50 mm	R2.5	R _t 3.4	R _t 2.9	R _t 2.8	R _t 2.8
70 mm	R3.5	R _t 4.4	R _t 3.9	R _t 3.8	R _t 3.8
90 mm	R4.5	R _t 5.4	R _t 4.9	R _t 4.8	R _t 4.8

The R-values shown are Total R-values for the building element as required by the Energy Provisions of the Building Code of Australia. Kingspan Kooltherm® products are manufactured, tested and packaged in conformance with AS/NZS 4859.1:2002 - Amdt 1. The contribution of the product Total R-values depends on installation and environmental conditions. The R-value will be reduced in the event of the accumulation of dust on the upward facing surfaces and in those cavities that are ventilated.

Fire Performance

Test	Test Method	Result
Ignitability, Flame spread	AS 1530.3	0/0/0/0-1
Heat release, Smoke release		
Group Classification	AS/NZS 3837	Group 1
FM Class No. 4880*	UBC 26-3	Class 1

** This approval is valid for ceiling / soffit installation only, with non-combustible walls and a floor to ceiling / soffit height restriction of 9.1m. Please contact us for correct installation instructions.*

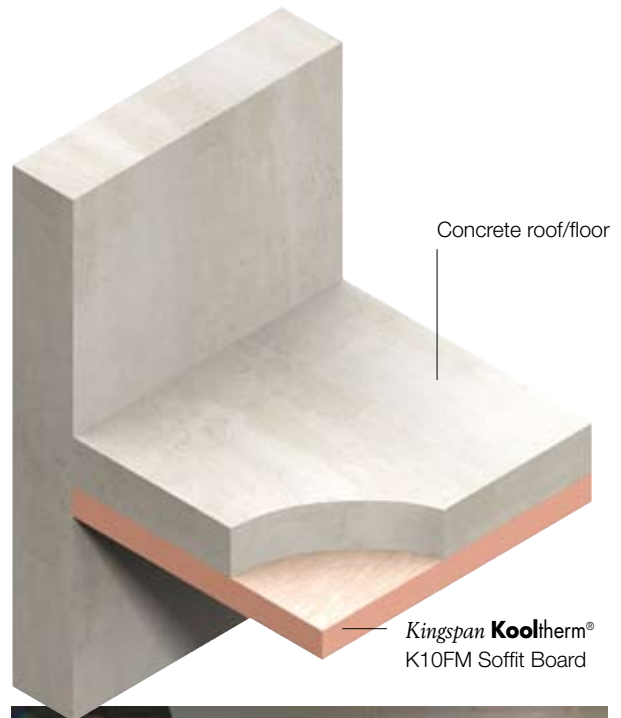

Kingspan Insulation Pty Ltd

Tel: 1300 247 235

Email: info.au@insulation.kingspan.com

www.insulation.kingspan.com.au

© Kingspan, Kooltherm, the zo Device and the Lion Device are Registered Trademarks of the Kingspan Group plc in Australia and other countries. All rights reserved.